

BLADE RUNNER EM10

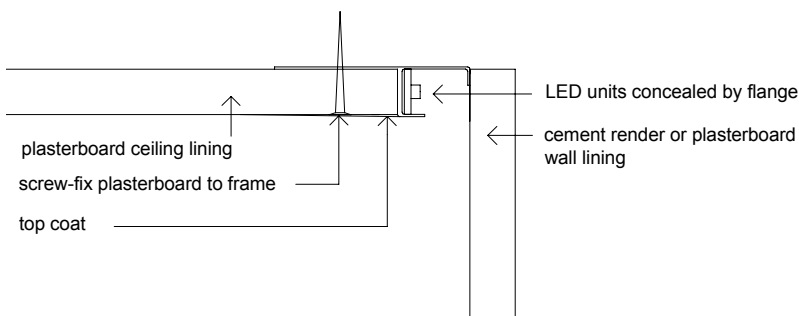
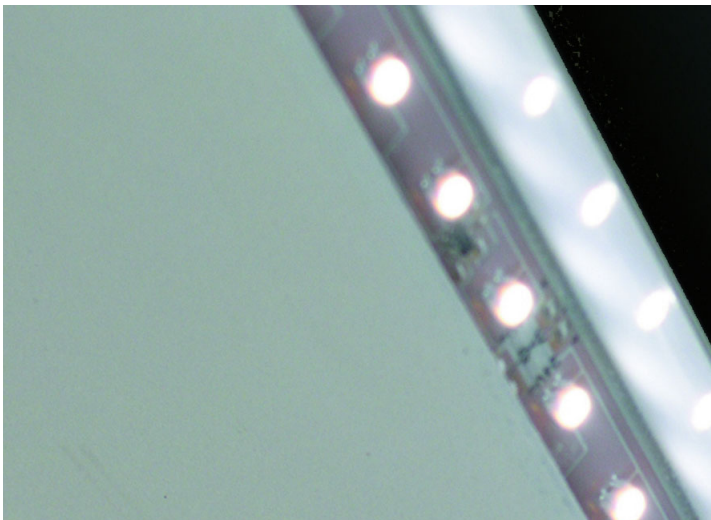

FIXING GUIDE

The BLADE RUNNER is designed to be fitted in place of a standard shadow-line bead in a 10 or 13mm plasterboard ceiling.

Frame up for the ceiling.

Screw-fix BLADE RUNNER into position.

Run cable from fitting to intended transformer access point (such as a nearby PHOENIX).

One transformer every 2.8m of Blade Runner (or part thereof) is required. The access point should be about 1.0m from the fitting, but no more than 2.5m maximum.

Fix the plasterboard ceiling lining into position over the flange of the BLADE RUNNER. Bond together with cornice cement.

A licensed electrician is to install the transformers.

Sand junction and paint as for surrounding ceiling.

The Blade Runner is a ceiling perimeter-mounted luminaire specifically designed to be flush-joined with a standard 13mm plasterboard ceiling. It transforms a 'shadow edge' into a striking feature at the junction between the ceiling and the wall.

E L E C T R I C A L

Transformer powered strip **LEDs**
