

CITYLIGHTS SPHERICAL

- FOR EUTRAC 1 CIRCUIT AND 3 CIRCUIT TRACK, WITH OR WITHOUT DATA BUS
- FOR EUTRAC LOW-VOLTAGE TRACK
- MADE OF DIE-CAST ALUMINIUM
- WITH EUTRAC 1 CIRCUIT ADAPTOR, EUTRAC 3 CIRCUIT ADAPTOR OR LOW-VOLTAGE ADAPTOR
- SILVER, WHITE OR BLACK FINISH

CITYLIGHT 70 FOR HIT-TC-CE



CITYLIGHT 70 FOR QR HALOGEN



CITYLIGHT 70 FOR HIT-TC-CE

	ADAPTOR	SILVER	WHITE	BLACK	Ø	H	L	W	DATA
1 x 20W	1~	SX 70-200-3	SX 70-200-1	SX 70-200-2	70	89	65	0.8kg	4990
1 x 20W	3~	SX 70-201-3	SX 70-201-1	SX 70-201-2	70	89	65	0.8kg	4990



CITYLIGHT 70 FOR QR-CB 51

	ADAPTOR	SILVER	WHITE	BLACK	Ø	H	L	W	DATA
1 x 20-50W	1~ DALI	SX 70-209-3	SX 70-209-1	SX 70-209-2	70	89	65	0.8kg	*
1 x 20-50W	3~ DALI	SX 70-204-3	SX 70-204-1	SX 70-204-2	70	89	65	0.8kg	*
1 x 20-50W	12V	SX 70-202-3	SX 70-202-1	SX 70-202-2	70	89	65	0.7kg	*
1 x 20-50W	1~	SX 70-208-3	SX 70-208-1	SX 70-208-2	70	89	65	0.8kg	*
1 x 20-50W	3~	SX 70-203-3	SX 70-203-1	SX 70-203-2	70	89	65	0.8kg	*

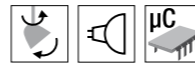

CITYLIGHT 70 FOR QPAR 16

	ADAPTOR	SILVER	WHITE	BLACK	Ø	H	L	W	DATA
1 x 35-50W	1~ DALI	SX 70-210-3	SX 70-210-1	SX 70-210-2	70	89	65	0.8kg	*
1 x 35-50W	3~ DALI	SX 70-207-3	SX 70-207-1	SX 70-207-2	70	89	65	0.8kg	*
1 x 35-50W	1~	SX 70-205-3	SX 70-205-1	SX 70-205-2	70	89	65	0.8kg	*
1 x 35-50W	3~	SX 70-206-3	SX 70-206-1	SX 70-206-2	70	89	65	0.8kg	*

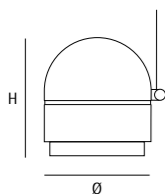
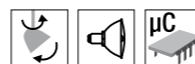

Ø: Diameter · H: Spotlight head height · L: Pendant rod length · W: Weight · Photometrics on request
*Light distribution according to photometrics of selected reflector lamp · 1~ abbreviation for 1 circuit · 3~ abbreviation for 3 circuit



CITYLIGHTS SPHERICAL

- FOR METAL HALIDE LAMPS
- FOR EUTRAC 1 CIRCUIT AND 3 CIRCUIT TRACK, WITH AND WITHOUT DATA BUS
- MADE OF DIE-CAST ALUMINIUM
- WITH EUTRAC 1 CIRCUIT OR 3 CIRCUIT ADAPTOR
- SILVER, WHITE OR BLACK FINISH

CITYLIGHT 130 FOR HIT-CE



CITYLIGHT 130 FOR HIR-CE



CITYLIGHT 130 FOR HIT-CE 12°

	ADAPTOR	SILVER	WHITE	BLACK	Ø	H	L	W
1 x 35W	1~	SX 130-200-3	SX 130-200-1	SX 130-200-2	130	132	110	1.8kg
1 x 35W	3~	SX 130-201-3	SX 130-201-1	SX 130-201-2	130	132	110	1.8kg
1 x 70W	1~	SX 130-240-3	SX 130-240-1	SX 130-240-2	130	132	110	1.8kg
1 x 70W	3~	SX 130-241-3	SX 130-241-1	SX 130-241-2	130	132	110	1.8kg

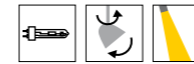

CITYLIGHT 130 FOR HIT-CE 39°

	ADAPTOR	SILVER	WHITE	BLACK	Ø	H	L	W
1 x 35W	1~	SX 130-242-3	SX 130-242-1	SX 130-242-2	130	132	110	1.8kg
1 x 35W	3~	SX 130-243-3	SX 130-243-1	SX 130-243-2	130	132	110	1.8kg
1 x 70W	1~	SX 130-244-3	SX 130-244-1	SX 130-244-2	130	132	110	1.8kg
1 x 70W	3~	SX 130-245-3	SX 130-245-1	SX 130-245-2	130	132	110	1.8kg



CITYLIGHT 130 FOR HIR-CE

	ADAPTOR	SILVER	WHITE	BLACK	Ø	H	L	W
1 x 35W	1~ DALI	SX 130-208-3	SX 130-208-1	SX 130-208-2	130	132	110	1.8kg
1 x 35W	3~ DALI	SX 130-209-3	SX 130-209-1	SX 130-209-2	130	132	110	1.8kg
1 x 70W	1~ DALI	SX 130-215-3	SX 130-215-1	SX 130-215-2	130	132	110	1.8kg
1 x 70W	3~ DALI	SX 130-217-3	SX 130-217-1	SX 130-217-2	130	132	110	1.8kg
1 x 35W	1~	SX 130-212-3	SX 130-212-1	SX 130-212-2	130	132	110	1.8kg
1 x 35W	3~	SX 130-213-3	SX 130-213-1	SX 130-213-2	130	132	110	1.8kg
1 x 70W	1~	SX 130-214-3	SX 130-214-1	SX 130-214-2	130	132	110	1.8kg
1 x 70W	3~	SX 130-216-3	SX 130-216-1	SX 130-216-2	130	132	110	1.8kg

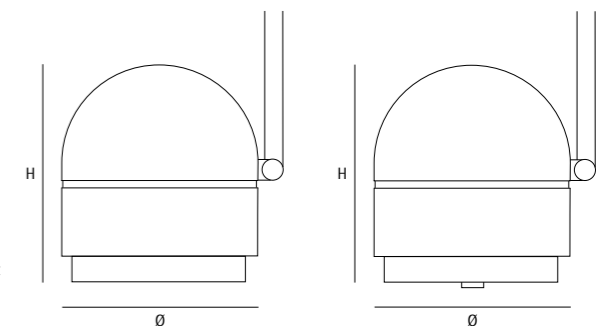
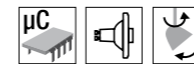

Ø: Diameter · H: Spotlight head height · L: Pendant rod length · W: Weight
Photometrics on request · CITYLIGHTS 130 accessories see page 177
1~ abbreviation for 1 circuit · 3~ abbreviation for 3 circuit



CITYLIGHTS SPHERICAL

- FOR EUTRAC 1 CIRCUIT AND 3 CIRCUIT TRACK, WITH OR WITHOUT DATA BUS
- MADE OF DIE-CAST ALUMINIUM
- WITH EUTRAC 1 CIRCUIT OR 3 CIRCUIT ADAPTOR
- SILVER, WHITE OR BLACK FINISH

CITYLIGHT 130 FOR QT 12

CITYLIGHT 130 FOR QR 111



CITYLIGHT 130 FOR QT 12 9°

	ADAPTOR	SILVER	WHITE	BLACK	Ø	H	L	W
1 x 100W	1~ DALI	SX 130-247-3	SX 130-247-1	SX 130-247-2	130	132	110	1.8kg
1 x 100W	3~ DALI	SX 130-205-3	SX 130-205-1	SX 130-205-2	130	132	110	1.8kg
1 x 100W	1~	SX 130-246-3	SX 130-246-1	SX 130-246-2	130	132	110	1.8kg
1 x 100W	3~	SX 130-204-3	SX 130-204-1	SX 130-204-2	130	132	110	1.8kg

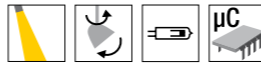

CITYLIGHT 130 FOR QT 12 29°

	ADAPTOR	SILVER	WHITE	BLACK	Ø	H	L	W
1 x 100W	1~ DALI	SX 130-249-3	SX 130-249-1	SX 130-249-2	130	132	110	1.8kg
1 x 100W	3~ DALI	SX 130-251-3	SX 130-251-1	SX 130-251-2	130	132	110	1.8kg
1 x 100W	1~	SX 130-248-3	SX 130-248-1	SX 130-248-2	130	132	110	1.8kg
1 x 100W	3~	SX 130-250-3	SX 130-250-1	SX 130-250-2	130	132	110	1.8kg

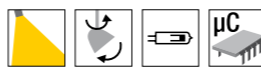

CITYLIGHT 130 FOR QR 111

	ADAPTOR	SILVER	WHITE	BLACK	Ø	H	L	W
1 x 100W	1~ DALI	SX 130-219-3	SX 130-219-1	SX 130-219-2	130	132	110	1.8kg
1 x 100W	3~ DALI	SX 130-207-3	SX 130-207-1	SX 130-207-2	130	132	110	1.8kg
1 x 100W	1~	SX 130-218-3	SX 130-218-1	SX 130-218-2	130	132	110	1.8kg
1 x 100W	3~	SX 130-206-3	SX 130-206-1	SX 130-206-2	130	132	110	1.8kg

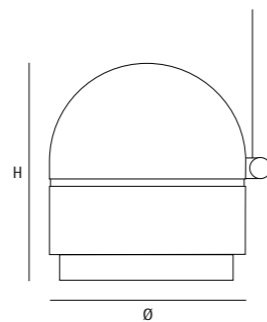
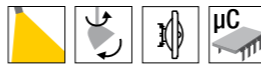

Ø: Diameter · H: Spotlight head height · L: Pendant rod length · W: Weight · Additional photometrics on request
 *Light distribution according to photometrics of selected reflector lamp · CITYLIGHTS 130 accessories see page 177
 1~ abbreviation for 1 circuit · 3~ abbreviation for 3 circuit

CITYLIGHTS OVERVIEW

		CITYLIGHT 70 CYLINDRICAL	CITYLIGHT 130 CYLINDRICAL	CITYLIGHT 70 SPHERICAL	CITYLIGHT 130 SPHERICAL
	12V Standard Adaptor			SX 70-222-.	SX 70-202-.
	1 circuit MultiAdaptor	SX 70-225-.	SX 130-272-.	SX 70-225-.	
	3 circuit MultiAdaptor	SX 70-226-.	SX 130-230-.	SX 70-206-.	
	1 circuit Electronic MultiAdaptor 35-105W	SX 70-228-.	SX 130-238-. SX 130-266-. SX 130-268-.	SX 70-208-.	SX 130-218-. SX 130-246-. SX 130-248-.
	3 circuit Electronic MultiAdaptor 35-105W	SX 70-223-.	SX 130-224-. SX 130-226-. SX 130-270-.	SX 70-203-.	SX 130-204-. SX 130-206-. SX 130-250-.
	1 circuit Electronic MultiAdaptor GO HIT 20W	SX 70-220-.		SX 70-200-.	
	3 circuit Electronic MultiAdaptor GO HIT 20W	SX 70-221-.		SX 70-201-.	
	1 circuit DALI-Dim Adaptor LV 35-100W	SX 70-229-.	SX 130-239-.	SX 70-209-.	SX 130-219-.
	1 circuit DALI-Dim Adaptor HV	SX 70-230-.	SX 130-267-. SX 130-269-.	SX 70-210-.	SX 130-247-. SX 130-249-.
	3 circuit DALI-Dim Adaptor LV 35-100W	SX 70-224-.	SX 130-225-.	SX 70-224-.	SX 130-205-.
	3 circuit DALI-Dim Adaptor HV	SX 70-227-.	SX 130-227-.	SX 70-207-.	SX 130-207-.
	1 circuit Multi-Compact Adaptor		SX 130-220-.		SX 130-200-.
	1 circuit Multi-Compact Adaptor with data bus contacts		SX 130-228-. SX 130-232-.		SX 130-208-. SX 130-212-.
			SX 130-234-.		SX 130-214-.
			SX 130-235-.		SX 130-215-.
			SX 130-260-.		SX 130-240-.
			SX 130-262-.		SX 130-242-.
			SX 130-264-.		SX 130-244-.
	3 circuit Multi-Compact Adaptor		SX 130-221-.		SX 130-201-.
	3 circuit Multi-Compact Adaptor with data bus contacts		SX 130-229-. SX 130-233-.		SX 130-209-. SX 130-213-.
			SX 130-236-.		SX 130-216-.
			SX 130-237-.		SX 130-217-.
			SX 130-261-.		SX 130-241-.
			SX 130-263-.		SX 130-243-.
			SX 130-265-.		SX 130-245-.

Colour code: ...-1 = White · ...-2 = Black · ...-3 = Silver

CITYLIGHTS 130 ACCESSORIES Illustrations see page 161

SX 98-160-0	Barn doors
SX 98-161-0	Lens protection cylinder
SX 98-162-0	Honeycomb louvre
SX 98-163-0	UV - filter dichroitic
SX 98-164-0	Infrared filter
SX 98-165-0	Sculpture lens
ON REQUEST	Colour filter