

serie/series  
**round  
brick light**  
NEW

**LED**  
powered by  
Citizen Electronics® LED  
Transformer included



simmetrico  
symmetric  
symétriques  
simétrico  
symmetrisch

example code:  
art. LED colour  
416 L60 H ngg  
art. electrification colour  
416 GU5.3 all

art.  
**416  
417  
418**

design **Ufficio Tecnico Landa**

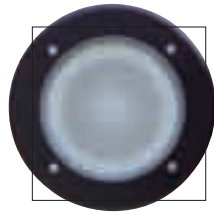

416 / 416M

frontale in alluminio /  
aluminium frame /  
cadre en aluminium /  
comis aluminio / Rahmen  
aus Aluminium

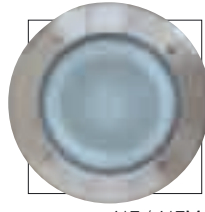

417 / 417M

frontale in acciaio inox  
AISI 316L / stainless steel  
AISI 316L frame / cadre  
en acier inoxydable AISI  
316L / cornis acero inox  
AISI 316L / Rahmen aus  
Edelstahl AISI 316L



418 / 418M

frontale in acciaio inox  
AISI 316L / stainless steel  
AISI 316L frame / cadre  
en acier inoxydable AISI  
316L / cornis acero inox  
AISI 316L / Rahmen aus  
Edelstahl AISI 316L

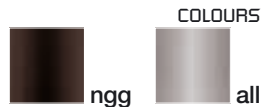

corpo **alluminio pressofuso**  
body **in die casting aluminium**  
corps **en aluminium moulé**  
**sous pression**  
cuerpo **aluminio inyectado**  
Körper **aus Aluminium-  
Druckguss**

diffusore **vetro opale**  
diffuser **glass opal**  
diffuser **verre opale**  
difusor **vidrio ópalo**  
Diffuser **Glas opal**

| Art.     | Art.     | Art.     | °C     | W      | V   | Type          |
|----------|----------|----------|--------|--------|-----|---------------|
| 416L60   | 417L60   | 418L60   | 5000°K | 4,8    | 240 | 430LM         |
| 416L60H  | 417L60H  | 418L60H  | 2900°K |        |     | 330LM         |
| 416L60B  | 417L60B  | 418L60B  | 50LM   |        |     |               |
| 416L60R  | 417L60R  | 418L60R  | 175LM  |        |     |               |
| 416GU5.3 | 417GU5.3 | 418GU5.3 | 140    | 1 X 50 | 12  | GU5,3         |
| 416G9    | 417G9    | 418G9    | 125    | 1 X 60 |     | G9            |
| 416GU10  | 417GU10  | 418GU10  | 160    | 1 X 50 |     | PAR 16 / GU10 |
| 416GX53  | 417GX53  | 418GX53  | 40     | 1 X 13 |     | GX53          |

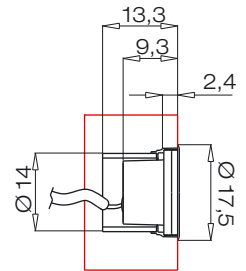

| Art.      | Art.      | Art.      | °C     | W      | V   | Type          |
|-----------|-----------|-----------|--------|--------|-----|---------------|
| 416L60M   | 417L60M   | 418L60M   | 5000°K | 4,8    | 240 | 430LM         |
| 416L60HM  | 417L60HM  | 418L60HM  | 2900°K |        |     | 330LM         |
| 416L60BM  | 417L60BM  | 418L60BM  | 50LM   |        |     |               |
| 416L60RM  | 417L60RM  | 418L60RM  | 175LM  |        |     |               |
| 416GU5.3M | 417GU5.3M | 418GU5.3M | 140    | 1 X 50 | 12  | GU5,3         |
| 416G9M    | 417G9M    | 418G9M    | 125    | 1 X 60 |     | G9            |
| 416GU10M  | 417GU10M  | 418GU10M  | 160    | 1 X 50 |     | PAR 16 / GU10 |
| 416GX53M  | 417GX53M  | 418GX53M  | 40     | 1 X 13 |     | GX53          |

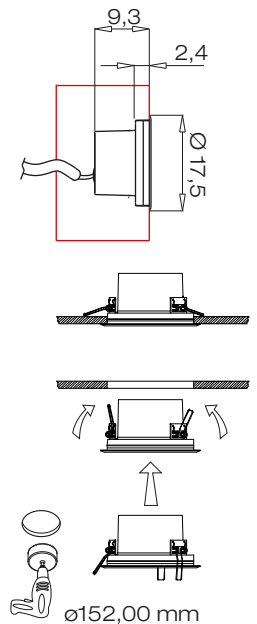

For technical details visit  
[www.landa.it](http://www.landa.it)

IP66

ELECTRIFICATION

**LED**

dettagli /  
details / details  
detalles / details:  
pages 4-5

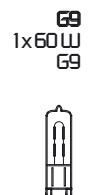
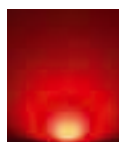
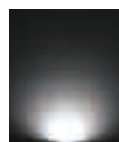



**LED**



Accessories on request:

**Antivandalism set**



X 4

00KAV02

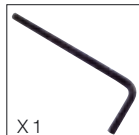

X 1

0303CA3

per/for/pour/  
para/für  
code: 416...

**Antivandalism set**



X 4

00KAV01

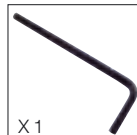

X 1

0303CA2.5

per/for/pour/  
para/für  
code: 417...  
code: 418...