



round  
brick light

serie/series

# round brick light

°C temperatura sul vetro  
 glass temperature  
 température de verre  
 temperatura del vidrio  
 Glastemperatur

art.  
**416/417**

design **Ufficio Tecnico Landa**

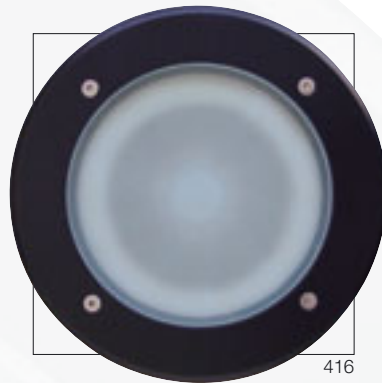

416

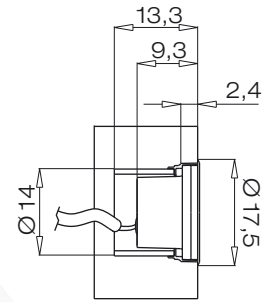

Art.	°C	W	Type	Light Bulb Icon
416 <b>GU5.3</b>	140	1 X 50		GU5,3
416 <b>G9</b>	125	1 X 60		G9
416 <b>GU10</b>	160	1 X 50	PAR 16 / GU10	

art. 416GU5.3 no transformer

frontale in alluminio

aluminium frame

cadre en aluminium

cornis aluminio

Rahmen aus Aluminium

corpo **alluminio pressofuso**  
 body **in die casting aluminium**  
 corps **en aluminium moulé**  
 sous pression  
 cuerpo **aluminio inyectado**  
 Körper **aus Aluminium-Druckguss**

diffusore **vetro opale**  
 diffuser **glass opal**  
 diffusor **verre opale**  
 difusor **vidrio ópalo**  
 Diffuser **Glas opal**



code 416.... nig

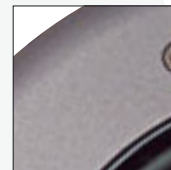

code 416.... all

colori  
 colours  
 couleurs  
 colores  
 Farben

**nig**  
**all**



417

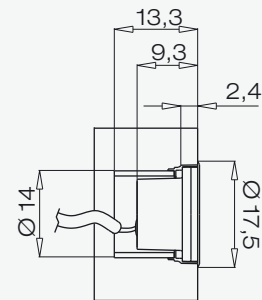

Art.	°C	W	Type	Light Bulb Icon
417 <b>GU5.3</b>	140	1 X 50		GU5,3
417 <b>G9</b>	125	1 X 60		G9
417 <b>GU10</b>	160	1 X 50	PAR 16 / GU10	

art. 417GU5.3 no transformer

frontale in acciaio inox AISI 316

stainless steel AISI 316 frame

cadre en acier inoxydable AISI 316

cornis acero inox AISI 316

Rahmen aus Edelstahl AISI 316

Available Photometrics data

IP66

tipo di lampadina  
 lamp type  
 type de lampes  
 tipo de lámpara  
 lampentyp

1 x 50 W - 12V  
 GU5,3



1 x 50 W  
 PAR 16 / GU10



1 X 60 W  
 G9

